

MAGNETIC SYSTEM INSTALLATION

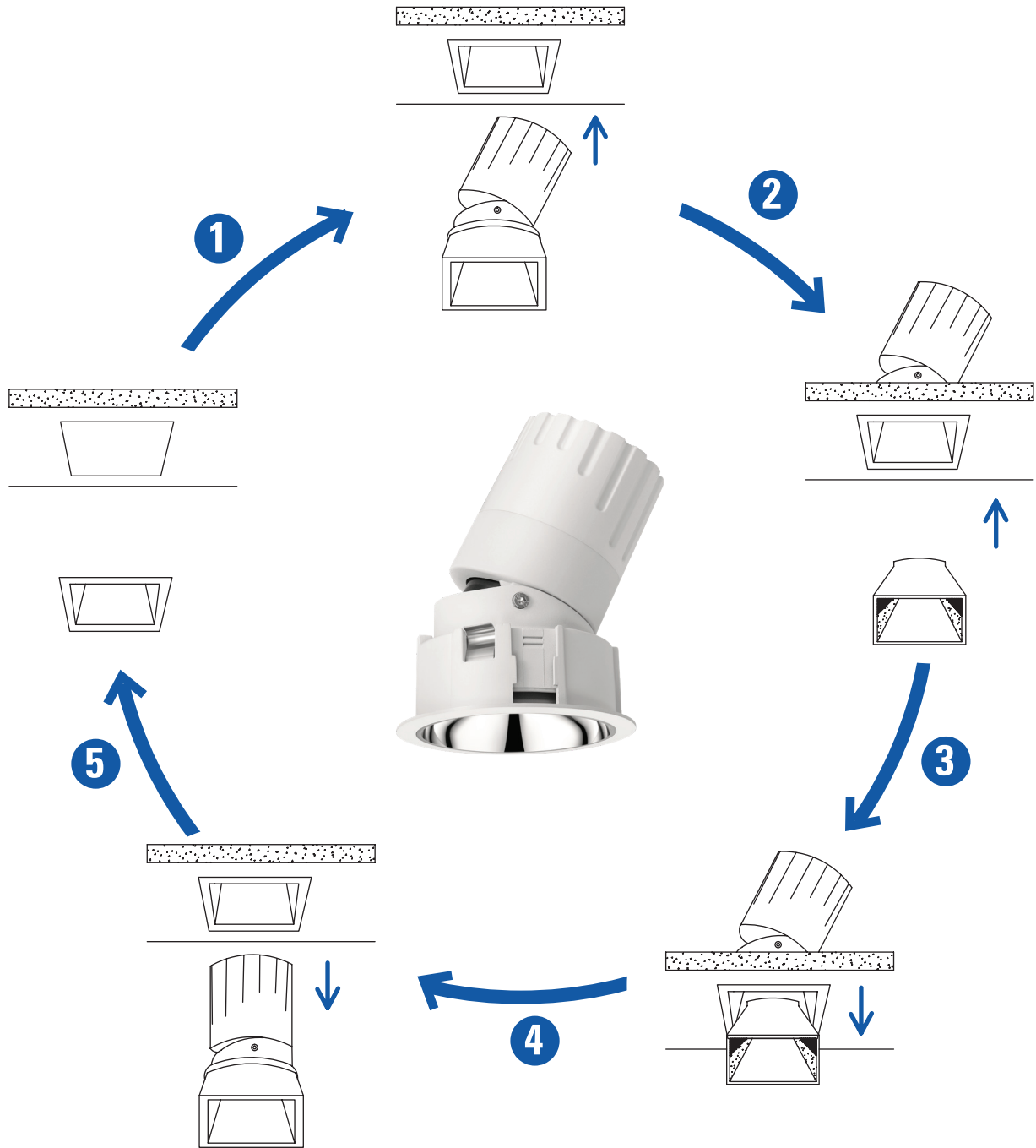

MAGNETIC ADSORPTION DOWNLIGHT

is one of Miron new launch and develop for architectural lighting. The installation of our downlight is equipped with an easy snap-in high performance reflector, the user can easy change the lamp by just snap-in-out the magnet reflector and it will not damage the ceiling system, like blaster ceiling tiles. User can also easy change a different beam angle reflector to aim different object . Product design is aiming to create a pleasant space through constant implementation of technological innovations intended to enhance high efficiency and safety and carry with a simple lamp replacement & maintenance method.

TIPS to consider when setting up a MIRON Magnetic Adsorption down light(s) :

NEW/ RETROFIT INSTALLATION or CHANGE TYPES OF REFLECTOR

1. Always make sure power to light fixtures is disconnected before beginning removal of existing trim or retrofit installation.
2. Remove existing lamp, trim, socket plate from housing, if there is.
3. Check and follow our Miron catalogue (www.miron-creation.com) about the correct ceiling cut out.
4. (Fig. 1) Snap in, connect driver(s) and fixture trim(s) into the ceiling system, and check the proper position if there is an additional require of aiming angle(s)
5. (Fig.2) Insert the correct model fixtures into the ceiling and fix it properly.
6. (Fig.3) Insert/ snap the magnet adsorption reflector
Check the power and turn on . Enjoy the light.

If needed the check the fixtures / lamp for maintenance, Again , always make sure power to light fixtures is disconnected before beginning removal of existing trim or retrofit installation.

7. (Fig. 4) Snap out the magnet adsorption reflector
- 8.(Fig. 5) Simple pull out the fixture and check as per needed.

磁 吸 附 筒 灯

是Miron (美朗) 在建筑照明领域新开发的产品之一。筒灯安装配备了一个简易的卡扣式高性能反射器, 用户只需卡扣磁铁反射器即可轻松更换灯具, 不会像爆破片一样损坏天花板系统。用户还可轻松更换不同波束角度的反射器来瞄准不同物体。产品设计旨在通过不断的技术创新来创造舒适空间, 以提高效率和安全性, 并采用简单的灯具更换和维护方法。

设置MIRON (美朗) 磁吸附筒灯应注意的事项:

新/更新安装或更换反射器

1. 在拆卸现有装饰圈或更新安装前, 确保断开灯具电源。
2. 如有, 从外壳上拆卸现有的灯、饰板、插座板。
3. 查看并参照Miron (美朗) 手册 (www.miron-creation.com) 关于如何正确从天花板拆卸。
4. (图1) 将驱动器和灯具内饰卡入连接天花板, 如有瞄准角度要求, 应检查位置是否准确。
5. (图2) 将正确型号的灯具插入天花板并固定。
6. (图3) 插入/卡扣磁吸附反射器。
检查电源并启动, 即可享受光亮。

如需检查维修灯具/灯泡, 同样在开始拆卸现有装饰圈或更新安装前, 确保断开灯具电源。

7. (图4) 卡出磁铁吸附反射器。
8. (图5) 直接拉出灯具以备检查。
9. 检查后按照第1 - 6点操作。